

G18JCS09XX Series HUG

33" folding grab bar, removable, stainless steel, ABS and aluminum flange cover,

Optional accessories for this product: F18AGS01, F18JMS01, F18JIS01

Product Data

Overall Dimensions (Inch.)	3-15/16 x 33-7/16 x 4-3/4
Net Weight (lbs.)	7.5

Installation Hardware Details

Screws not included

Packaging Details

Package	Nylon bag in cardboard packaging
Package dimensions (Inch.)	35 x 5-11/16 x 4-5/16
Package weight (lbs.)	8.22

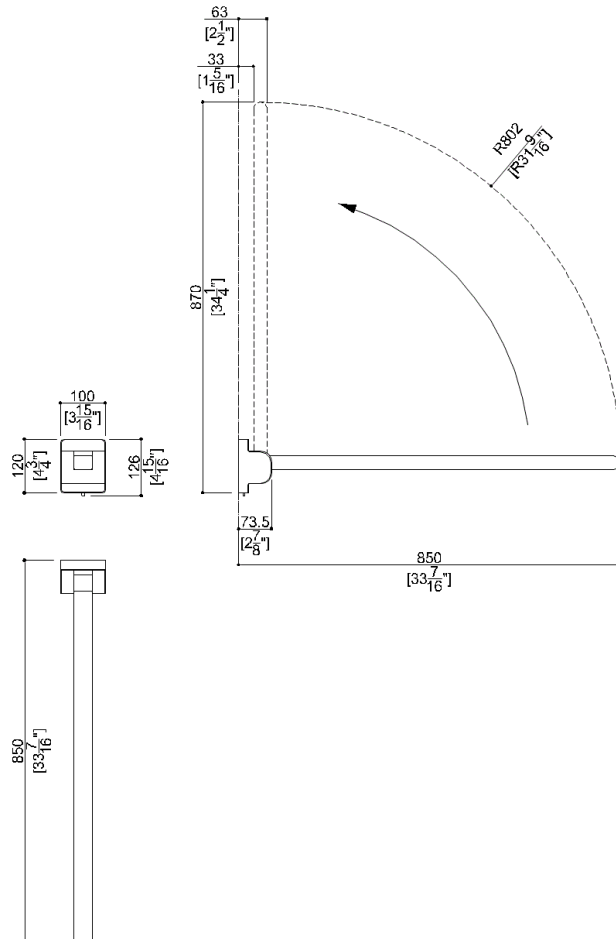

G18JCS09XX Series HUG

Y88JKS82

Alluminum fixing plate

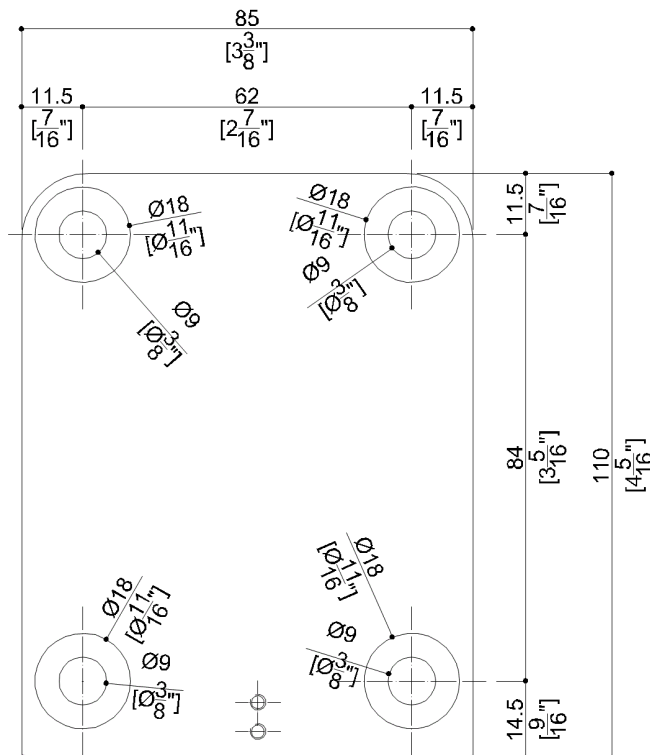

Available Finishes (xx)

Arm finish

C1	Chrome	DD	Graphite	PB	Coral
WE	Signal White				

Flange cover finish

C1	Chrome	D4	Dark Gray	PB	Coral
WE	Signal White				

Materials and finishes

Stainless steel	Glossy
Aluminium	N.A.
ABS	N.A.

Load Capacity

Vertical	331 lbs.	Horizontal	220 lbs.
----------	----------	------------	----------

Warning

Before installation and use, read the installation and use instructions in their entirety. If questions arise please contact Ponte Giulio company.

Cleaning

Product can be cleaned with a cloth and warm soapy water. Non abrasive, solvent free cleaners can also be used.

Warranty

Please visit www.pontegiulio.com for complete warranty details.